

### Brentwood Blvd.

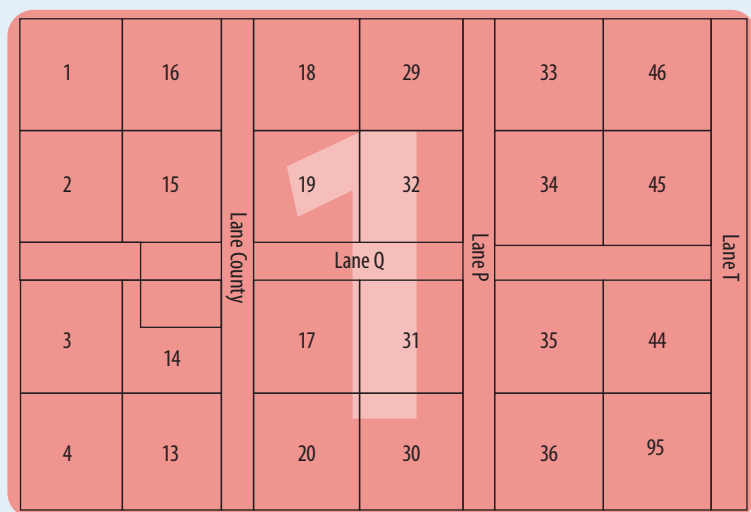

Preston Pass

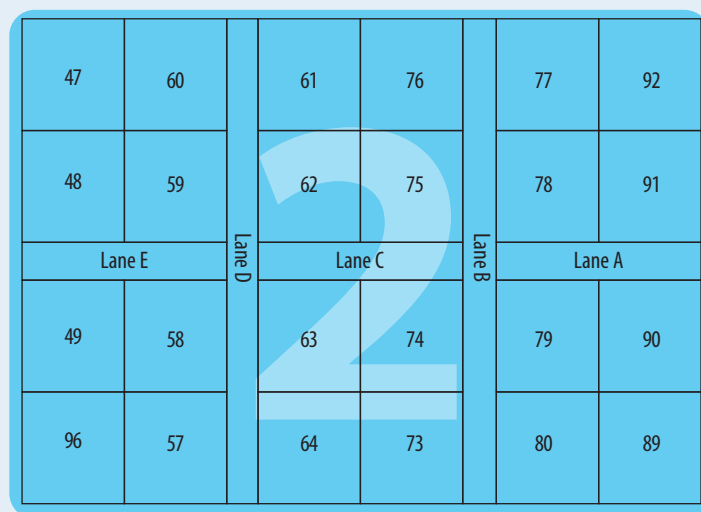

Cypress Lane

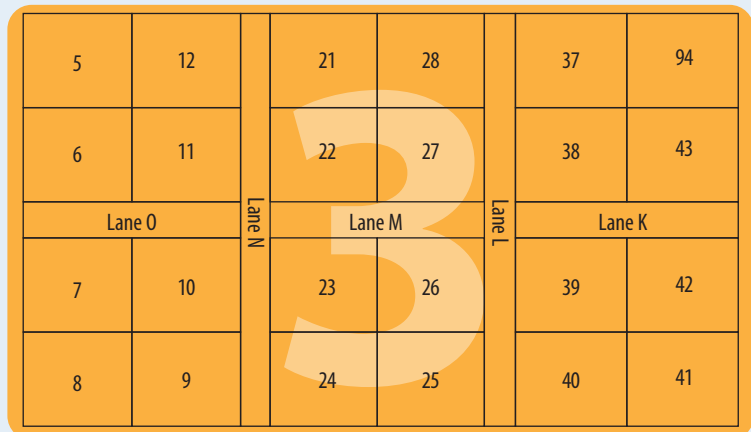

Donner Pass

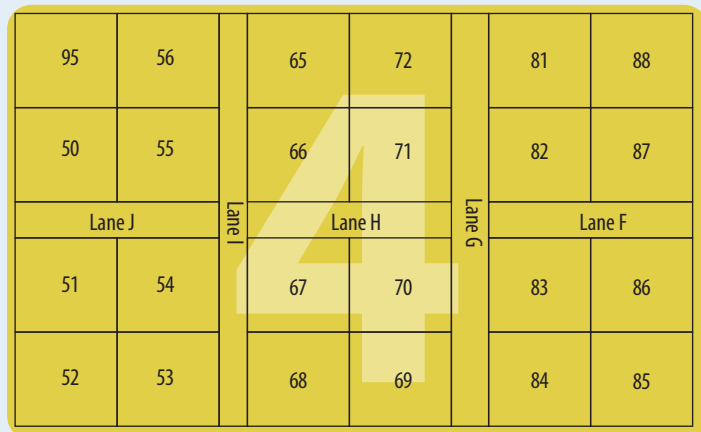

Willow Way

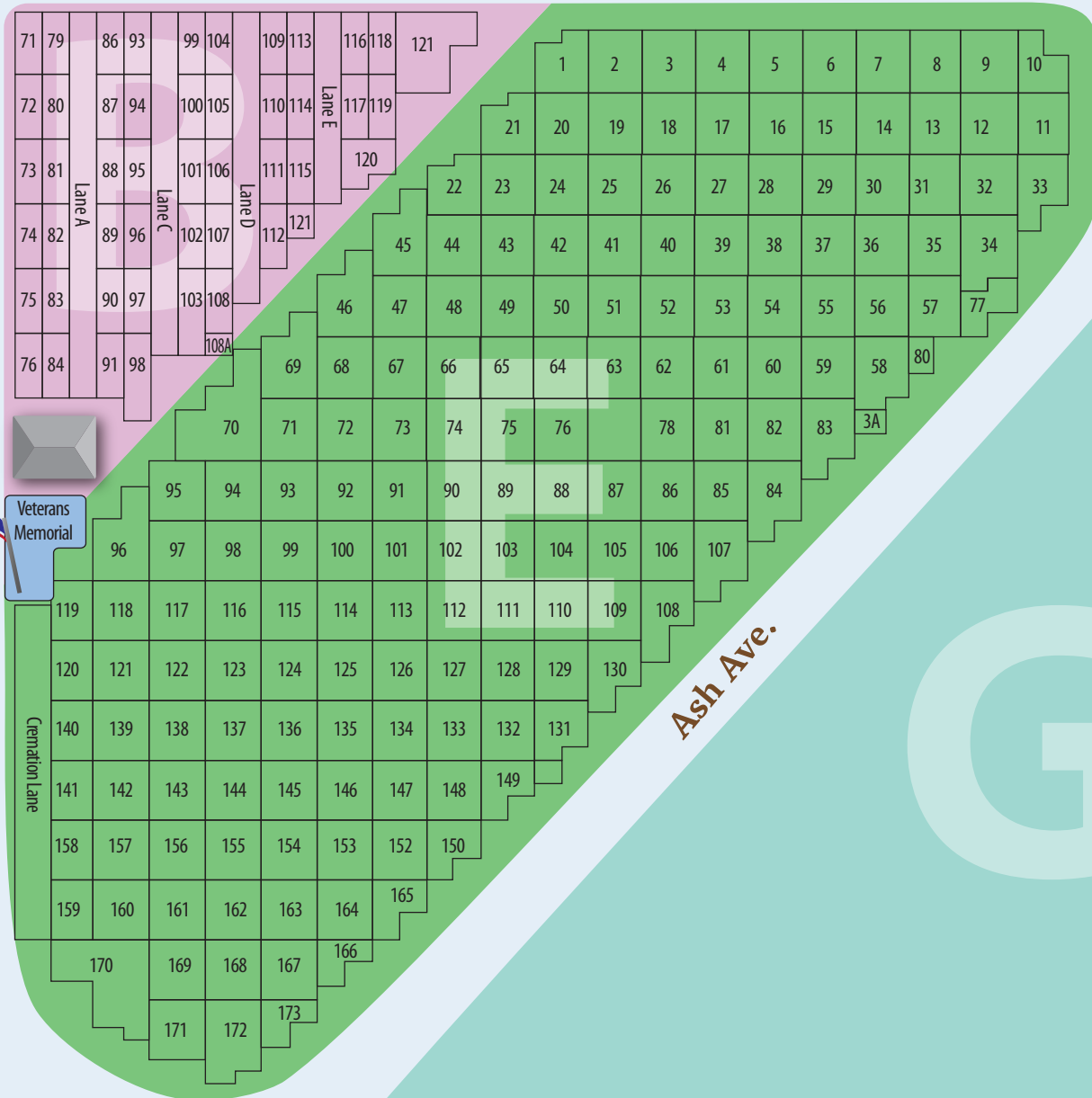

Memorial Lane



Veterans Memorial

Generation Lane

Ash Ave.

# G



Oleander Ave.

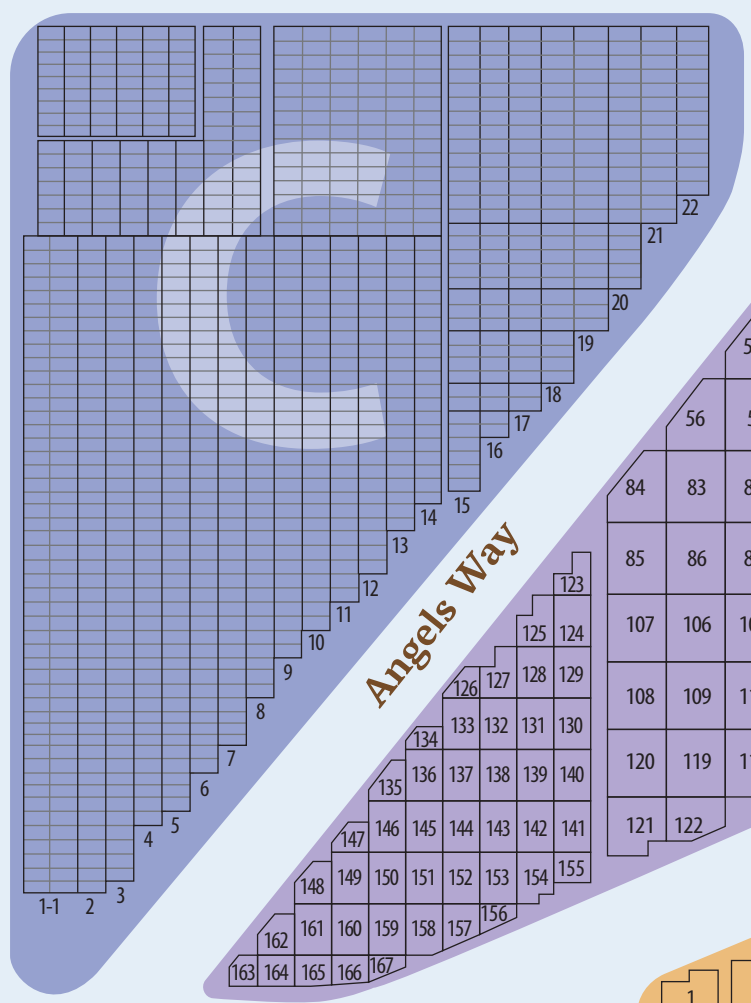

Angels Way

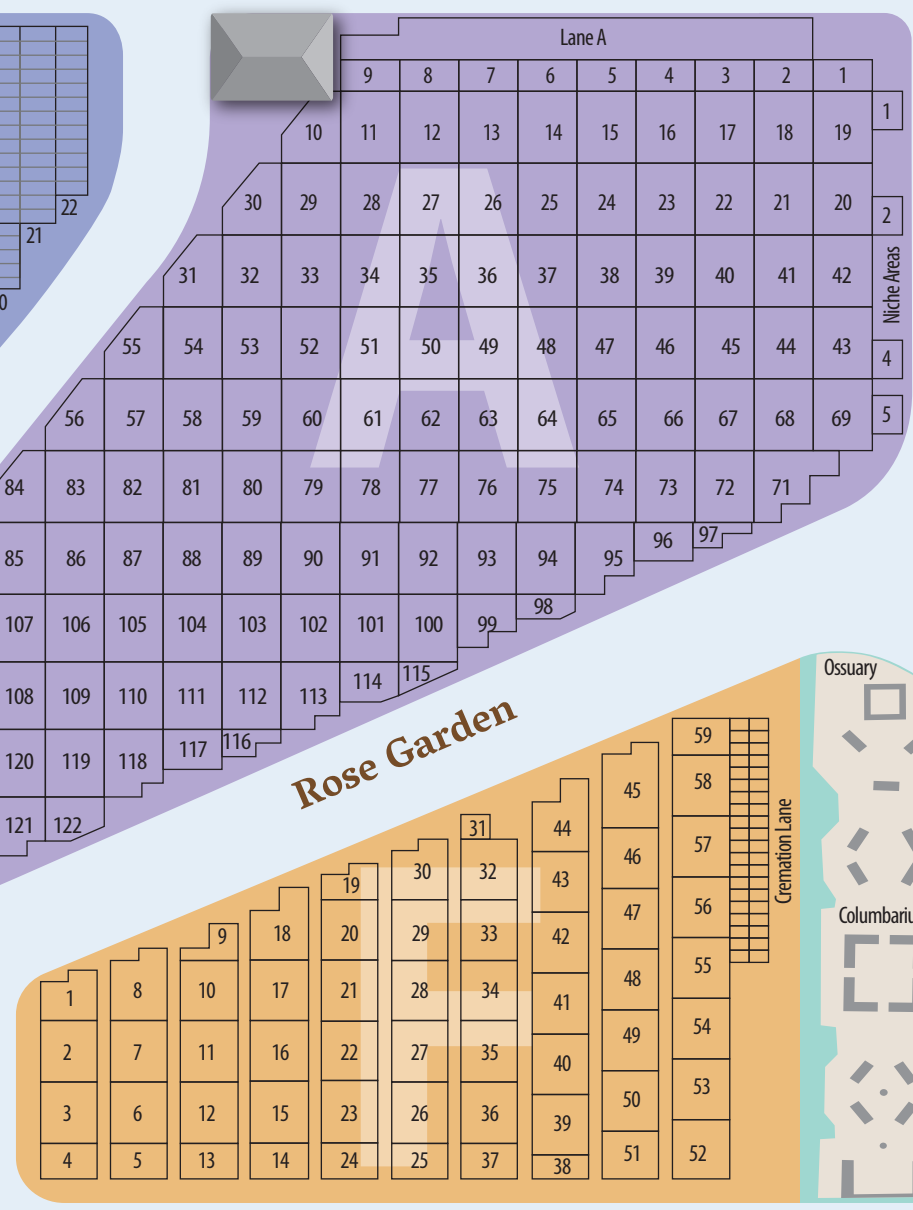

Rose Garden



Ossuary



Columbarium



Future Cemetery Office



Future Cremation Garden

Vista Diablo

Future Parking Area

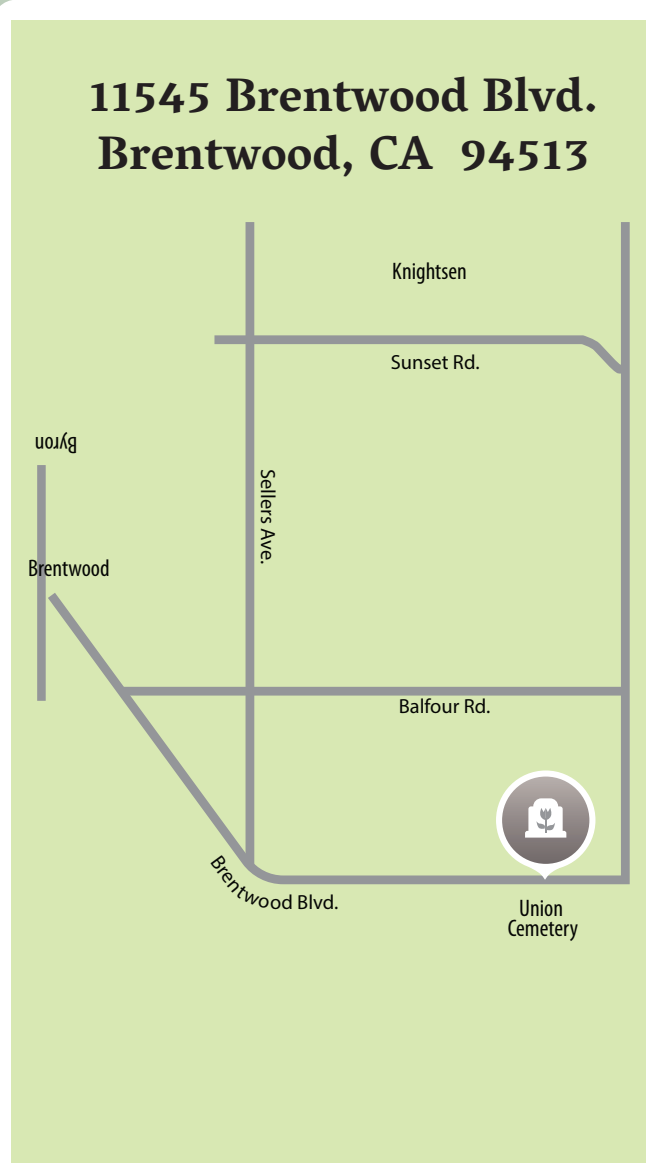

<https://www.bbkucd.org>

The cemetery grounds are open from 8:00 am to 5:00 pm.

### History

The Union Cemetery Association was established November 1, 1878, when Colburn Preston, a pioneer from the Point of Timber area, sold four acres, specifying that the land must be used solely for a cemetery. Prior to that, burials were performed on family property or at the Point of Timber graveyard on the Will's Ranch, located at the present-day Marsh Creek Road and State Highway Route 4 (Byron Highway). After the new BBKUCD cemetery opened, burials were moved away to the newer site. This reason is why BBKUCD has headstones from before the 1878 District founding date.



### Cemetery Rules & Etiquette

Our cemetery provides a beautiful place to visit year-round. It may feel like a park when you are visiting, but please remember that these are sacred burial grounds. We ask that you respect and follow these rules and regulations when you visit. In general, please be respectful to other visitors and the grounds.

### Privacy and Quiet

- Respect the privacy of other patrons visiting graves or attending services.
- Keep noise levels to a minimum.
- No loitering.
- No use of profanity.
- No music.

### Visiting

- No alcoholic beverages of any kind are permitted.
- You may need to step over other graves to reach a loved one's grave. It is acceptable to do so, but please watch your step for vases, gravestones and sprinkler heads.
- No climbing or sitting on or pushing on monuments.
- Vandalism is prohibited, illegal, and will be prosecuted.
- Keep the cemetery clean and use provided garbage cans.
- Children under 16 must be accompanied by an adult.
- Pets must be on leash and should stay on paved roadways. Clean up after your pet.

### Grave Sites

- No glass, ceramic, concrete or breakable containers or statuary are allowed at any grave site.
- No planting of trees, bushes, shrubs or any other type of foliage.
- No lighting devices are allowed. This includes solar devices.
- Only flowers are allowed whether real, plastic or silk. Flowers must be placed on markers or in containers provided. Only 2 - 3" or smaller in size potted plants will be permitted per site

### Vehicles

- Drive at a safe speed at all times not to exceed 5 mph.
- Parking along the roadside is permitted, although do not park in front of an open interment site unless you are part of the funeral procession.
- No parking or driving on the grass is permitted.
- Turn music off or down so that it cannot be heard outside of the vehicle.
- The cemetery closes at 5 pm. Vehicles must leave the grounds.

### Disclaimers

The Byron-Brentwood-Knightsen Union Cemetery District assumes no responsibility for lost or damaged flowers or other items placed at a grave site. Items are subject to weathering, wind damage, sun damage, theft or routine maintenance activity. The District also reserves the right to remove any and all damaged items from any grave at the time such items are determined to be damaged and non-serviceable. For further information, please see the District's Public Policy. This is an endowment care facility.



**Simon Taylor Barkley (1847-1941)**  
**Sarah E. Barkley (1862-1932)**  
 Unit 1, Block 14  
 Simon and Sarah Barkley's marriage was the second to be recorded at Brentwood Township. Their five girls and seven boys all graduated from Liberty Union High School.



**Christian Heidorn (1848-1908)**  
**Dorothy Heidorn (1855-1951)**  
 Unit 1, Block 34  
 Christian Heidorn came to California with brother Heinrich in 1868 from Germany, where they had been forest rangers for the government. By the 1890s, Heidorn Ranch had increased to more than 800 acres, dedicated to wheat, nuts, fruit and a fine vineyard. Produce was shipped to market via Babbe's Landing He was the first president of the Knightsen Irrigation Company.



**Edna Hill (1892-1975)**  
 Unit 1, Block 34  
 Edna Heidorn Hill was the youngest of Christian and Dora's three children. She attended San Jose Normal College, now San Jose State University. She became the Superintendent of the Brentwood School District in 1930, an office she held for seven years before returning to the class-room. On May 15, 1955, the Brentwood Middle School was named Edna Hill School to honor Brentwood's most distinguished educator.



**Henry W. Heidorn (1875-1946)**  
 Unit 1, Block 34  
 In 1904, Henry Heidorn, the son of Christian, established and ran Heidorn General Store with his sister, Emma White, nee Heidorn on Knightsen's Main Street. Henry also served the community as Justice of the Peace. He was instrumental in forming the Knightsen Irrigation Company and was Knightsen's postmaster for many years.



**Richard R. Veale (1864-1937)**  
 Unit 1, Block 45  
 Richard Rains Veale, born in Sonoma County, arrived in the Eden Plains region with his family at the age of four in 1867. He received his education at Iron House School, and began stock raising and farming on Veale Tract. He was a prominent farmer as a young man and is credited with being the first in the area to use modern methods such as steam plows and harvesters. He became the Contra Costa County Sheriff in 1894 when the county was still untamed and served continuously until 1935. At the time, this was a record for the longest continuous service of any Sheriff in the United States. Following that, Richard was elected Treasurer of Contra Costa County, a post he held until his death in 1937.



**Robert Garwood Dean (1831-1920)**  
**Jerusha H. Dean (1836-1925)**  
 Unit 1, Block 44  
 Robert Garwood Dean came to California from New York in 1850 on the schooner Francisco, which turned out to be a seven-month trip. He was the first president of the Bank of Brentwood. He was also instrumental in establishing a high school in Brentwood.



**Frances E. (Donner) Wilder (1840-1921)**  
 Unit 3, Block 41  
 Frances was one of the ill-fated Donner party which tried crossing the Sierra Nevada Mountain Range during an early winter. Later, Frances married William R. Wilder, in 1858, and then settled a farm in the Point of Timber area (present day Byron).



**Jose Sanchez (1875-1946)**  
**Clotilde Sanchez (1880-1950)**  
 Section C  
 Jose and Clotilde Sanchez, both from Andalusia, Spain, are examples of European emigrants finding opportunity in east Contra Costa County. The couple initially contracted in 1913 with the C&H Sugar Company as laborers in the Hawaiian sugar cane fields. After fulfillment of their contract, the Sanchez's came to California in 1917 where they once again worked as contract laborers on Bradford Island. Industry, money saving habits, and availability of land in Brentwood enabled them to buy 22 acres of irrigated farmland.



**Joseph Percy Carey (1833-1910)**  
 Unit 2, Block 49  
 Joseph Carey, a native of Amsterdam, New York, crossed the plains at the age of twenty with brother, Levi, seeking gold. He married Mary A. Steel on November 19, 1861. In February 1866 he married Laura A. Welch of Illinois with whom he had five children. With the Tulare and San Pablo Railroad surveying a new route, Carey saw opportunity. One of Brentwood's first residents, Carey established the very first business in Brentwood. He and partner Solomon P. Davis established a blacksmith and repair service in 1874 with the firm name "Carey & Davis Blacksmith."



**William ("Bill") Bristow (1935-2009)**  
 Section D, Block 38, Lot 4  
 Bill Bristow, born in Arkansas, arrived in eastern Contra Costa County during the depression as a one-year-old child. The family moved to Brentwood when Bill was in grammar school where they worked on Tony Ghozzi's farm on Marsh Creek Road. Bill graduated from Liberty Union High school, excelling in sports. After graduating from San Francisco State University, he began teaching at Knightsen Elementary School. Bill wrote curriculum and educational modules for Byron, Knightsen, Brentwood and Liberty school districts. Bill held the position of Brentwood Superintendent of Schools for over 25 years. The William B. Bristow Middle School in Brentwood is named after him.



**George W. Knight (1843-1931)**  
**Christina C. Knight (1856-1936)**  
 Section B, Block 14



The founder of Knightsen was born in Maine and sailed to California in 1874 via the Isthmus of Panama. He purchased 110 acres in the Eden Plain district, which was located where the town of Knightsen is today. His wheat and hay farm were so successful, he was able to purchase the adjoining 80 acres and expand his crops to include almonds. When the Santa Fe Railroad Company wanted to route a line from Oakland to Stockton through his fields, he offered them enough land for a passing track and a station if they would move farther west and cut off just a corner of his ranch. In gratitude, the Superintendent of the Santa Fe Railroad named the town Knightsen by adding the "sen" from his wife, Christina's, maiden name, Christensen.



**Historic Figures  
 And  
 Notable Residents**